

**Fox**  
**Mountain**  
FIFTH WHEELS

**EXPLORE**  
**QUALITY**



[www.northwoodmfg.com](http://www.northwoodmfg.com)



## **FOX MOUNTAIN STANDARD FEATURES**

**NORTHWOOD BUILT, INDEPENDENTLY CERTIFIED, OFF-ROAD CHASSIS  
FULLY WELDED, THICK-WALL ALUMINUM FRAME CONSTRUCTION  
MORryde STEP ABOVE ENTRY STEP WITH STRUT ASSIST  
ONE-PIECE, CORONA TREATED, CONTINUOUS FIBERGLASS  
HOT, POLYURETHANE LAMINATED, MULTI-LAYERED SUBSTRATE WALLS  
HIGH DENSITY BLOCK FOAM INSULATION \* LED EXTERIOR & INTERIOR LIGHTING  
STAINLESS STEEL APPLIANCES \* SOLID SURFACE COUNTERTOPS  
INTERIOR COMMAND CENTER \* EXTERIOR CONVENIENCE CENTER  
ADJUSTABLE PITCH CAREFREE TRAVEL'R 12V LED AWNING  
12-VOLT POWER LANDING GEAR \* GENERATOR READY**



**235RLS HARMONY INTERIOR**

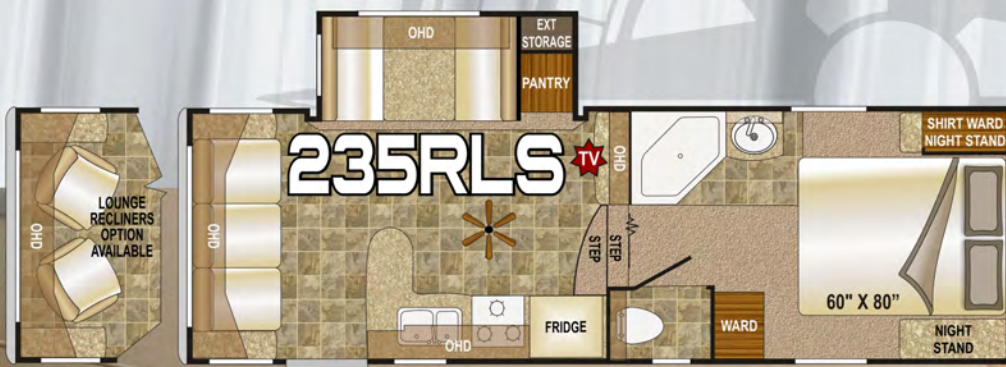

# START LIVING ON MOUNTAIN TIME



**255RKS MIRAGE INTERIOR**

# FOX MOUNTAIN FIFTH WHEELS

## FEATURES AND OPTIONS



### Standard Construction Features

Northwood Built, Independently Certified, Off-Road Chassis  
Fully Welded, Thick-Wall Aluminum Frame Construction  
One-Piece, Corona Treated, Continuous Fiberglass  
Hot, Polyurethane Laminated, Multi-Layered Substrate Walls  
High Density Block Foam Insulation  
Cathedral Arched Ceiling

### Standard Exterior Features

EZ Lube Axles w/Nev-R Adjust Forward, Self Adjusting Brakes  
Equaflex Axle Suspension System  
Aluminum Wheels / Tires & White Mod Spare  
Powered Sliding Stab Jacks, Rear  
MORryde Step Above w/Strut Assist  
All-Conditions / Four Seasons Insulation w/ R-18 Ceiling  
R-15 Reflective Foil Insulation in Slide / Roof  
Heated Holding Tanks and Dump Valves  
Fiberglass High Gloss Gel Coat Front Cap  
Roto-Flex Suspension Pin Box  
Color-Keyed Sidewalls and Skirts  
Diamond Plate Bumper Wrap  
LED Exterior Lighting  
Roof Rack & Ladder  
Exterior Convenience Center  
Exterior Shower / Black Water Flush System  
Large Exterior Entry Grab Handle  
Entry Door Friction Hinge  
Carefree Travel'R 12V LED Awning w/Adjustable Pitch Hardware  
Omni-Directional TV Antenna  
20 Watt Solar Panel / Sidewall Solar Port  
12-Volt Power Landing Gear / Battery Disconnect  
Tinted, Safety Glass Windows  
Generator Ready / Satellite Ready / Solar Ready  
Security Light

### Standard Heat Power & Water Equipment

Semi-Automatic Winterization / By-Pass System  
6 Gal DSI Gas / Electric Quick Recovery Water Heater  
13.5m BTU A/C w/ Condensation-Resistant Ducting

### Standard Interior Features

LED Utility Lighting & Decorative Lighting  
Interior Command Center / Digital Thermostat  
Bedroom Carpet w/ Pad / Charge Wizard  
Contemporary Interior Styling  
Roller Bearing Drawer Glides  
Fabric Day/Night Shade Window Treatments  
LED TV & DVD/CD AM/FM Player w/Bluetooth  
FanTastic Vent w/ Remote/Tstat/Rain Sensor in Bedroom

### Kitchen/Bathroom/Bedroom Features

Solid Surface Kitchen Countertops  
Stainless Steel Appliances  
Residential, Built-In Microwave  
High Output 3-Burner Range with Range Cover  
Designer Fox Mountain Backsplash / Ceiling Fan  
Extra Large Fridge (10 Cu Ft) w/ Stainless Look Panels  
Porcelain, Foot-Pedal Toilet / Bath Skylight  
FanTastic Exhaust Vent in Bathroom  
Glass Shower Enclosure / Garden Tub  
TruRest Queen Mattress & Bedspread  
Below Bed Storage  
Bedroom Pre-Wired & Blocked for Flat Screen  
Bedroom Roof Vent  
Pillow Shams  
Designer Headboard  
Shirt Wardrobe Cabinets  
Night Stand Top and Drawer  
Reading Lights / Electrical Outlets  
USB Charging Center on Both Sides of the Bed

### Standard Safety Features

Break-Away Switch  
GFI Circuit Protection  
Smoke, LPG, & CO Leak Detector  
Fire Extinguisher  
Dead Bolt Lock on Entry Door  
Egress Windows (emergency escape)

### Options

29" Surround-Soundbar  
Slide Awning Topper  
Alumaguard Main Awning  
19" 12v LED TV Bedroom  
15K A/C w/ Ducting / 15K Low Pro A/C w/ Ducting  
3.6 Onan Generator / Holding Tank Heat Pads  
100w or 170w Solar Panel / Thermal Pane Windows  
Lounge Recliners / LED TV Bedroom  
Free-Standing Table w/ 4 Chairs  
Rear View Window

Model Number	235RLS	255RKS
Dry Axle Weight (approx. Lbs.)	6405	7080
Dry Hitch Weight (approx. Lbs.)	1905	1880
Net Carrying Capacity	3190	2540
Gross Dry Weight-lbs (approx. Lbs.)	8310	8960
Gross Vehicle Weight Rating (GVWR)-Lbs.	11500	11500
Exterior Length (approx. w/ hitch)	27'10"	29'10"
Exterior Height (approx. incl. AC unit)	12'9"	12'10"
Exterior Width (approx. w/o awning)	8'0"	8'0"
Tire Size	ST235 80R16	ST235 80R16
Load Range	E	E
Fresh Water w/water heater (approx gal)	59	60
Gray Water Tank (approx. gallons)	42	35/40
Black Water Tank (approx. gallons)	36	35
LPG Capacity (approx. gallons)	14	14
CSA - Canadian Dealers Only	YES	YES
Auto Ignition Furnace (1,000 BTU's)	30	30

\*All dry weights are calculated on full featured production units. Verify the towing capacity of your tow vehicle. If you don't know or aren't sure, you can ask your automotive dealership or contact your tow vehicle manufacturer. All weights above are average approximations and may vary. Weights are calculated before adding options.

Your Northwood Dealer

Updated July 2019

Northwood Manufacturing, 59948 Downs Rd., PO Box 3359, La Grande, OR 97850 (541) 962-6274 - [www.northwoodmfg.com](http://www.northwoodmfg.com)

Photos, drawings, dimensions and weights are presented as accurate but may differ from current production models. We continually upgrade & improve our products and reserve the right to change any specifications without notice. Please see your authorized Northwood dealer for updated information.