



Quality By Design

[www.northwoodmfg.com](http://www.northwoodmfg.com)

# RUGGED LITE SNOW RIVER



quality is in our nature

FIBERGLASS FRONT CAP WITH BACK ROADS ARMOR PROTECTION



*Cathedral Arched Ceiling*



*Forest Interior*

*246 RKS*



*Sunset Interior*

*246 RKS*

266 RDS



Rustic Cabin Finish

Rustic Flooring

Sunset Interior

266 RDS



Forest Interior

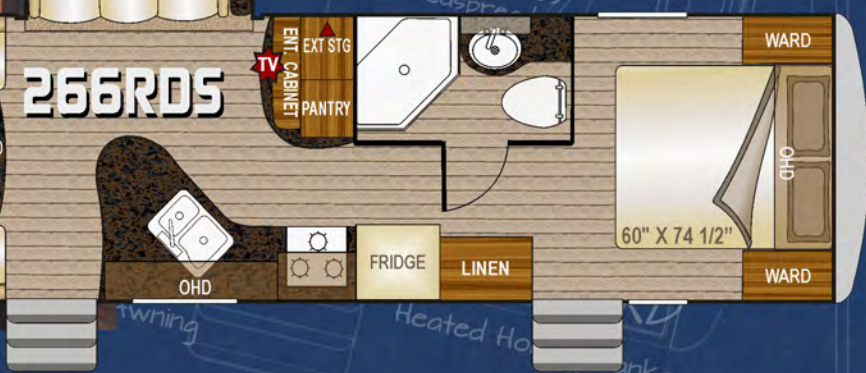

# What is Snow River 'Rugged Lite' Construction?

## All The Strength, Without The Weight.

- \* Northwood Built, 3rd Party Independently Tested & Certified, Structural Steel Off-Road Chassis.
- \* Heavy Duty Axles w/ Larger Wheels & Brakes for Clearance, Load Capacity & Stopping Power.
- \* Fully Welded Heavy Gauge Aluminum Super Structure.
- \* Multi-layer Laminated Walls over High Density Block Foam Insulation.
- \* Corona Treated Continuous One-Piece Outer Fiberglass Skin.
- \* Tongue & Groove Plywood Sub Floor (not chipboard).
- \* Double Arched Roof Trusses Bonded to Plywood Decking.

We build it **RUGGED** and we keep it **LITE** for ease of towing and fuel efficiency. Every Snow River posts its finished weight right at the entry door for your 'Rugged Lite' assurance.

**RUGGED PROTECTION**



**ALUMINUM SUPERSTRUCTURE**

# SNOW RIVER RUGGED LITE

## Standard Construction Features

Northwood Built, Independently Certified, Off-Road Chassis  
Fully Welded, Thick-Wall Aluminum Frame Construction  
One-Piece, Corona Treated, Continuous Fiberglass  
Hot-Polyurethane Laminated, Multi-Layered Substrate Walls  
High Density Block Foam Insulation  
Cathedral Arched Ceiling  
All-Conditions / Four Seasons Insulation w/ R-14 Ceiling  
R-15 Reflective Foil Insulation in Roof / Slide  
Darco One-Piece RV Under-Siding  
5/8" Tongue-and-Groove Main Floor Decking  
Full Walk-On Roof with 3/8" Decking  
1/2" Decking for Bed and Bunk Platforms

## Standard Exterior Features

Universal Lube Axles  
Equaiflex Axle Suspension System  
15" "Black Out" Aluminum Wheels  
Stabilizer Jacks  
Fiberglass Front Cap w/ BackRoad Armor  
Dramatic "Rugged/Lite" Eagle Graphic Package  
Molded ABS LP Tank Cover  
Diamond Plate Bumper Wrap  
4" Sewer Hose Carrier Bumper  
LED Exterior Lighting  
Safari Tuff Roof Rack and Ladder  
SLAM Door Latches on Pass Thru Storage Doors  
Cooler-Sized Storage Access Doors  
Black Water Flush System  
Extend-A-Flow LP Feed for BBQ  
Exterior Shower (Most Models)  
Large Exterior Entry Grab Handle  
Carefree Travel'R 12V Awning  
TV Antenna  
Outside Speakers  
Tinted Windows

## Standard Interior Features

Residential Wear Floor Covering  
LED Interior Utility Lighting  
Interior Command Center  
Rustic Cabin Finish Throughout  
Roller Bearing Drawer Glides  
Mini Blind Privacy Shades Throughout  
LCD TV & DVD/CD AM/FM Player  
Snow River Signature Compass / Temperature Gauge Shelf  
"Hearthstone" Laminate Countertops & Backsplash

## Standard Heat, Power, and Water Equipment

6 Gal DSI Gas / Electric Quick Recovery Water Heater  
13.5M BTU Air Conditioner  
Condensation-Resistant Ceiling Ducting  
Efficient Residential-Style In Floor Ducted Heating  
20 Watt Solar Panel  
Satellite Ready / Solar Ready  
Heated Holding Tanks  
Semi-Automatic Winterization / By-Pass System  
12V Electrical System w/ Deluxe 110V 55-Amp Converter  
25 Foot - 30 Amp Park Power Cord  
Auto-Ignition Furnace w/ Wall Thermostat  
120v GFI Protected Exterior Patio Outlet  
12V Demand Water Pump System  
Hook-Up For City Water  
Two (2) 30 Lbs. Propane Tanks w/ Regulator  
Water Heater By-Pass

## Standard Safety Features

Break-Away Switch  
Dual Safety Chains On A-Frame  
GFI Circuit Protection  
Smoke, LPG, & CO Leak Detector  
Fire Extinguisher  
Dead Bolt Lock On Entry Door  
Egress Windows (Emergency Escape)

## Standard Kitchen Features

Residential, Built-In Microwave  
High Output 3-Burner Range w/ Range Cover  
Large Fridge (6 Cu Ft) w/ Insert Panels  
Real Wood Custom Cutting Board  
22" Oven  
Range Hood w/ Light and Exhaust Fan  
Acrylic Residential-Style Sink  
High Profile Galley Faucet  
Sink Cover / Cutting Board  
Galley Overhead Storage Cabinets  
Ventilating Window at Kitchen Sink  
Large Picture Window at Dinette  
Large Dinette Table  
Laminated Countertops  
Durable, Polyethylene Holding Tanks

## Standard Bathroom Features

Foot-Pedal Toilet / Bath Skylight  
Bath Exhaust Fan  
Large Sink  
Medicine Cabinet w/ Mirror

## Standard Bedroom Features

Camping Comfort Mattress & Bedspread  
Below Bed Storage  
Bedroom Pre-Wired & Blocked for Flat Screen  
Bedroom Roof Vent  
Pillow Shams  
Designer Headboard  
Shirt Wardrobe Cabinets  
Night Stand Top and Drawer  
Reading Lights  
Electrical Outlets

## Options

Slide Awning Topper  
CSA (Canadian Dealers Only)  
Deluxe Refer Doors  
Spare Tire Group  
12V Power Jack  
Thermal Pane Windows  
Night Shades  
Powered Sliding Stab Jacks, Front & Rear  
Travel'R Awning Adj. Pitch Hardware  
60 Watt Solar Panel w/ Controller  
100 Watt Solar Panel w/ Controller



See your dealer for option availability in certain models

Model Number	234RBS	246RKS	266RDS
Dry Axle Weight (approx. Lbs.)	5260	5040	5514
Dry Hitch Weight (approx. Lbs.)	690	750	718
Net Carrying Capacity	4050	4210	3768
Gross Dry Weight-lbs (approx. Lbs.)	5950	5790	6232
Gross Vehicle Weight Rating (GVWR)-Lbs.	10000	10000	10000
Exterior Length (approx. w/hitch)	26'10"	28'4"	31'1"
Exterior Height (approx. incl. AC unit)	11'7"	11'7"	11'7"
Exterior Width (approx. w/o awning)	8'0"	8'0"	8'0"
Tire Size	ST225 75R15	ST225 75R15	ST225 75R15
Load Range	D	D	D
Fresh Water w/ Water Heater (approx. gal.)	59	59	59
Gray Water Tank (approx. gal.)	42	35/35	35
Black Water Tank (approx. gal.)	35	36	36
LPG Capacity (approx. gal.)	14	14	14
CSA - Canadian Dealers Only	YES	YES	YES
Auto Ignition Furnace (1,000 BTU's)	25	25	25

## Your Local Dealer:

Send us your testimonial with your pictures and you may be featured in our future promotions.

Send your information to:  
[feedback@northwoodmail.com](mailto:feedback@northwoodmail.com)



Updated May 2017

Northwood Manufacturing, 59948 Downs Rd., PO Box 3359, La Grande, OR 97850 (541) 962-6274 - [www.northwoodmfg.com](http://www.northwoodmfg.com)

Photos, drawings, dimensions and weights are presented as accurate but may differ from current production models. We continually upgrade & improve our products and reserve the right to change any specifications without notice. Please see your authorized Northwood dealer for updated information.